

- NOTES:**
1. DIRECTIONAL LIGHTING TO BE USED SO AS NOT TO AFFECT ADJACENT PROPERTIES
  2. MAXIMUM HEIGHT 10' FOR UNRESTRICTED LIGHTING AND 15' FOR 90° CUTOFF LIGHTING (PER SECTION 18-213.2 (a) (8) OF CITY OF WILMINGTON LAND DEVELOPMENT CODE.
- GENERAL NOTES:**
1. ALL PAVEMENT MARKINGS IN PUBLIC RIGHTS-OF-WAY & FOR DRIVEWAY ARE TO BE THERMOPLASTIC & MEET CITY AND/OR NCDOT STANDARDS.
  2. TRAFFIC CONTROL DEVICES (INCLUDING SIGNS AND PAVEMENT MARKINGS) IN AREAS OPEN TO PUBLIC TRAFFIC ARE TO MEET MUTCD (MANUAL ON UNIFORM TRAFFIC CONTROL DEVICES) STANDARDS.
  3. CONTACT TRAFFIC ENGINEERING AT 341-7888 FORTY- EIGHT (48) HOURS PRIOR TO ANY EXCAVATION IN THE RIGHT OF WAY.
  4. ANY BROKEN OR MISSING SIDEWALK PANELS, DRIVEWAY PANELS AND CURBING WILL BE REPLACED.
  5. CONTACT TRAFFIC ENGINEERING TO DISCUSS SITE LIGHTING OPTIONS. THE LANDSCAPING PLAN WILL BE NEEDED TO DETERMINE SITE LIGHT LOCATIONS.
  6. TACTILE WARNING MATS TO BE INSTALLED AT ALL WHEELCHAIR RAMPS.
  7. ALL TRAFFIC CONTROL SIGNS AND MARKINGS OFF THE RIGHT-OF-WAY ARE TO BE MAINTAINED BY THE PROPERTY OWNER IN ACCORDANCE WITH MUTCD STANDARDS.
  8. ALL PARKING STALL MARKINGS AND LANE ARROWS WITHIN THE PARKING AREAS SHALL BE WHITE.
  9. A UTILITY CUT PERMIT IS REQUIRED FOR EACH OPEN CUT OF A CITY STREET. CONTACT CITY ENGINEERING FOR MORE DETAILS. IN CERTAIN CASES AN ENTIRE RESURFACING OF THE AREA BEING OPEN CUT MAY BE REQUIRED.
  10. INSTALL REFLECTORS PER CITY AND NCDOT STANDARDS. TRAFFIC ENGINEERING MUST APPROVE OF PAVEMENT MARKING LAYOUT PRIOR TO ACTUAL STRIPING.
  11. A LANDSCAPING PLAN SHALL BE SUBMITTED TO THE CITY OF WILMINGTON TRAFFIC ENGINEERING DIVISION AND PARKS AND RECREATION FOR REVIEW AND APPROVAL PRIOR TO THE RECORDING OF THE FINAL PLAT.
  12. TRAFFIC ENGINEERING MAY BE CONTACTED REGARDING THE UTILITIES IN ROW. BUT CONTACT 811 PRIOR TO CONTACTING CITY OF WILMINGTON.

For each open utility cut of City streets, a \$325 permit shall be required from the City prior to occupancy and/or project acceptance.

**Approved Construction Plan**

	Name	Date
Planning		
Traffic		
Fire		

**CITY OF WILMINGTON**  
NORTH CAROLINA  
Public Services • Engineering Division  
APPROVED STORMWATER MANAGEMENT PLAN  
Date: \_\_\_\_\_ Permit # \_\_\_\_\_  
Signed: \_\_\_\_\_

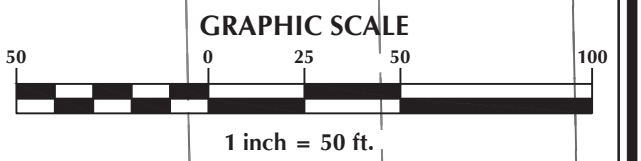



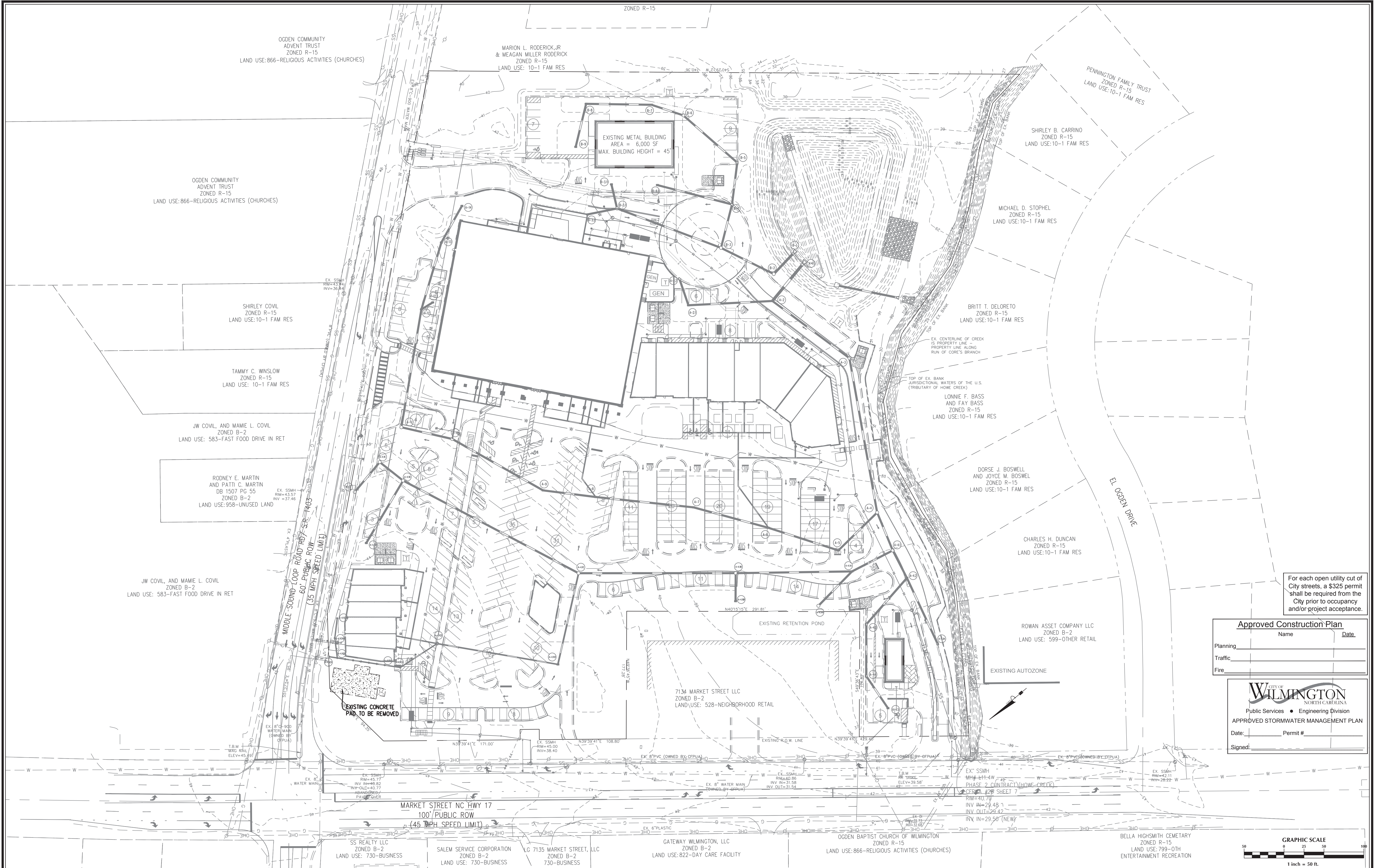

For each open utility cut of City streets, a \$325 permit shall be required from the City prior to occupancy and/or project acceptance.

Approved Construction Plan		
	Name	Date
Planning		
Traffic		
Fire		

CITY OF WILMINGTON NORTH CAROLINA	
Public Services	Engineering Division
APPROVED STORMWATER MANAGEMENT PLAN	
Date:	Permit #
Signed:	

No.	Revision	Date	By

Designer	GSP	Scale	1" = 50'
Drawn By	GSP	Date	March 2020
License #	P-0718	Job No.	2016-0012

Wilmington

OGDEN MARKET PLACE  
EXPANSION

New Hanover County

North Carolina

# EXISTING CONDITIONS PLAN

PREPARED FOR:  
HALPERN ENTERPRISES, INC  
5269 BUFORD HIGHWAY  
ATLANTA, GEORGIA 30340  
404-537-3462

GSP CONSULTING, PLLC  
ENGINEERING

6626 Gordon Road Unit C Wilmington, North Carolina 28411 tel: 910-442-7870 fax: 910-799-6659